

**BTB's patented adjustable cutting depth control system ensures you can cut with precision and confidence and only cut as deep as required, avoiding unnecessary damage to the pinchweld, blade, mouldings or glass.**

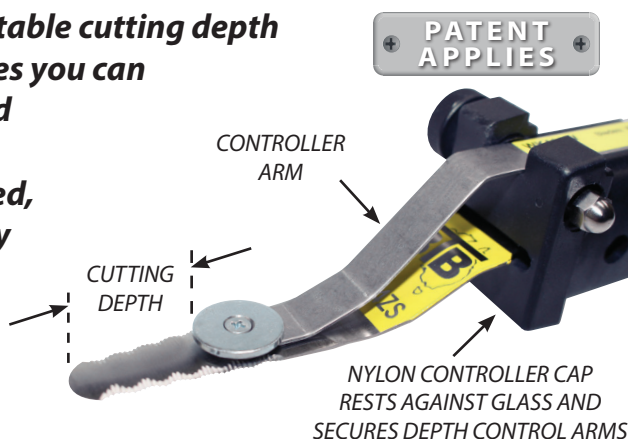

## CONTROLLER ARM WHEELS

Controller Arms with the **THIN** 1mm wheel are designed to roll smoothly along uneven (in and out) urethane surfaces.

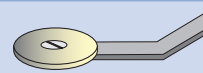

Controller Arms with the **THICK** nylon wheel are designed to roll along A-pillar trim, soft headliner or vehicle body panel.

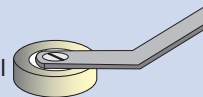

## Controller Arms For Offset Z Blades

### WK11AW

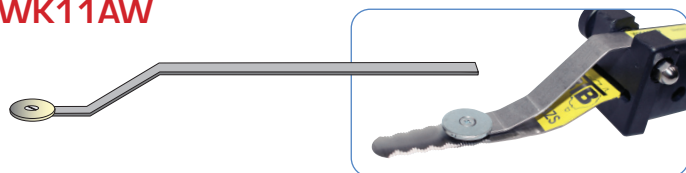

### WK11BW5

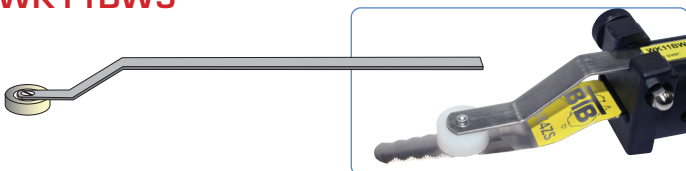

#### Blades:

WK4Z,  
WK4Z-S,  
WK24Z,  
WK24Z-S,  
WK5Z-S,  
WK5ZR-S,  
WK18Z,  
WK18Z-S,  
WK19Z-S,  
WK24ZV,  
WK24ZV-S.

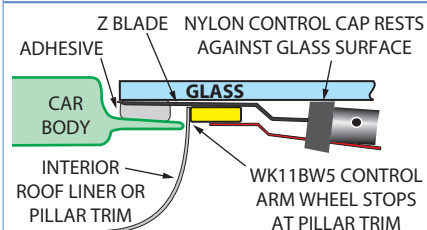
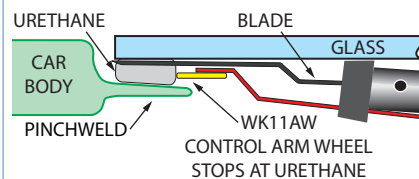

## Controller Arms For Reverse Blades

### WK11CW



While cutting against pinchweld (**not against the glass**), use the WK11CW control arm underneath all **ORANGE** and **BLUE** reverse blades, to provide support to reciprocating blade and avoiding flapping.

**IMPORTANT!**

#### For Blades:

Long end for:  
WK24ZR-S,  
WK24ZVR-S,  
WK24R-S.

Short end for:  
WK4ZR-S,  
WK4ZVR-S,  
WK4R-S.

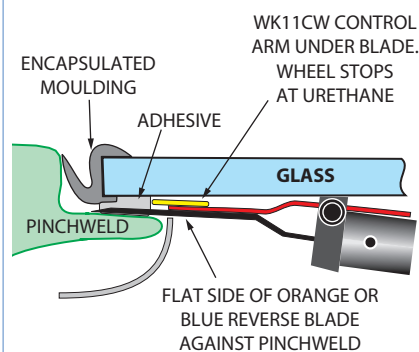

## Controller Arm For Short Straight Blades

### WK11DW5



#### For Blades:

WK2, WK2-S,  
WK3, WK3-S,  
WK4, WK4-S,  
WK4R-S,  
WK5, WK5-S,

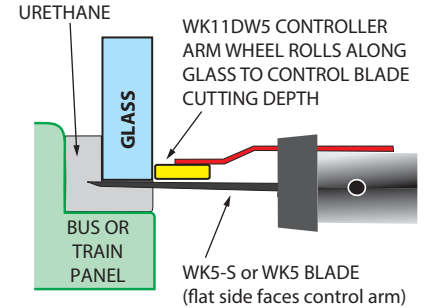

## Controller Arms For Long Blades

### WK11EW



#### For Blades:

WK1,  
WK1-S,  
WK19L,  
WK19L-S.

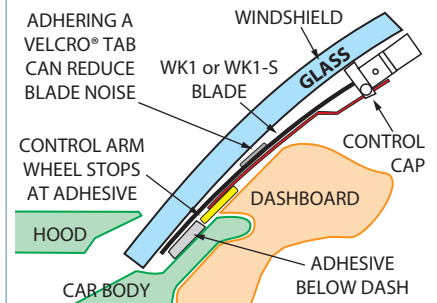

## Controller Arm For Mid-Length Straight & Bent Blades

### WK11FW



#### For Blades:

Long end for:  
WK2, WK2-S,  
WK24, WK24-S,  
WK24R-S.

Short end for:  
WK3, WK3-S,  
WK4, WK4-S,  
WK4R-S.

